

(2) Replacing Pressure Arm Assembly

1. Remove the media guide R2.

👉 **"4.2.8 Removing Media Guide R2" p.4-14**

2. Remove the media guide stay a screw (cup screw M3 × 6, Ni-3bk: 5), and tilt it to the far side.

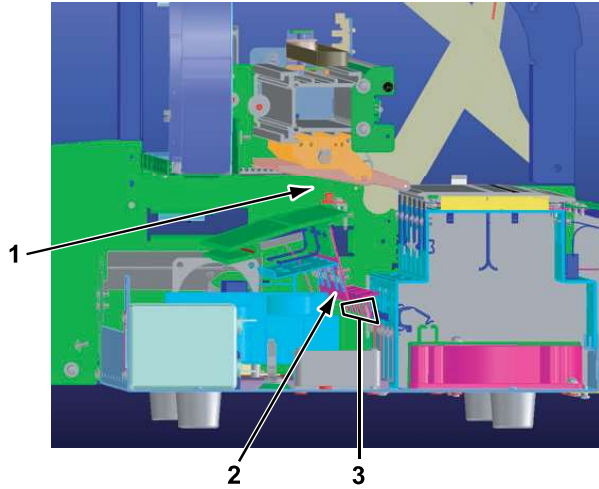

No.	Part name
1	Pressure arm assembly
2	Media guide stay a (at slant angle)
3	Media guide a-retaining screw (cup screw M3 × 6, Ni-3bk)

3. Remove the pressure spring.

👉 **"(1) Replacing Pressure Spring" p.4-45**

4. Remove the pressure arm assembly and replace it through the front space of tilted media guide stay a.
5. To reassemble the unit, reverse the removal procedure.

4.6 Replacement of Head Section Components

4.6.1 Replacing Print Head

NOTE

- Before replacing the print head, remove the R side cover or the top cover.

☞ ["4.2.1 Removing R Side Cover" p.4-6](#)

☞ ["4.2.6 Removing Top Cover" p.4-12](#)

1. Perform ink discharge operation to discharge ink entirely from the ink paths.

NOTE

Cover the platen surface by placing media before performing ink discharging so that the ink does not spill on the platen directly.

TIP

☞ ["5.7.8 HeadWash Menu" p.5-43](#)

2. Initialize the shot count of the print head.
☞ ["5.7.8 HeadWash Menu" p.5-43](#)
3. Release the CR locker by pushing it with your finger, then move the carriage from the capping position to the left.
4. Remove the CR board cover-retaining screw (M3 × 8, S tight cup: 1).

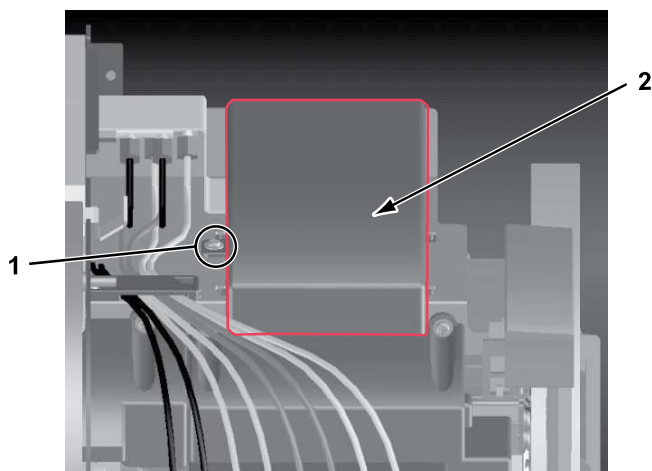

No.	Part name
1	CR board cover screw (M3 × 8, S tight cup)
2	CR board cover

- 5. Remove the CR board cover.
- 6. Remove the cable cover L-retaining screw (pan-head screw with spring washer and flat washer M3 × 8 W sems: 2) (tapping screw M3 × 8, S tight cup: 1).

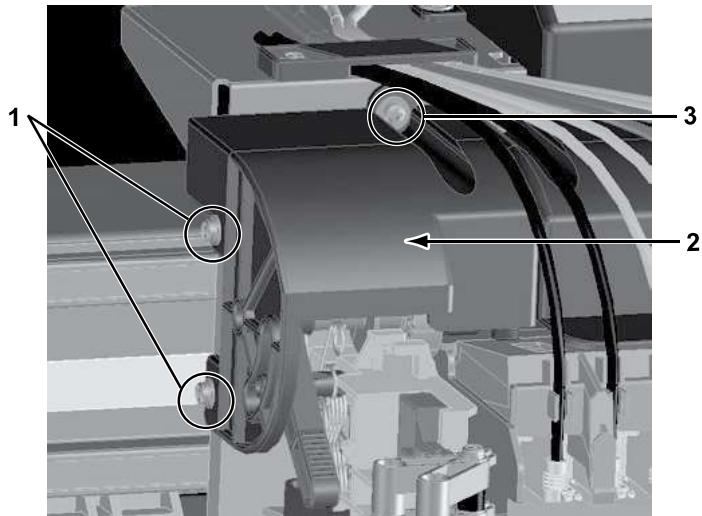

No.	Part name
1	Cable cover L screw (M3 × 8 pan-head screw with spring washer and flat washer W sems)
2	Cable cover L
3	Cable cover L screw (M3 × 8, S tight cup)

- 7. Remove the cable cover R-retaining screw (tapping screw M3 × 8, S tight cup: 2) (pan-head screw with spring washer and flat washer M3 × 8 W sems: 1).

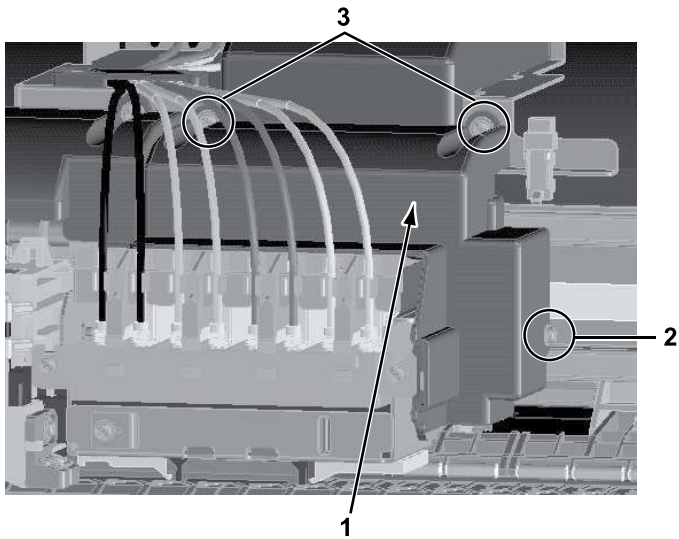

No.	Part name
1	Cable cover R
2	Cable cover R screw (M3 × 8 pan-head screw with spring washer and flat washer W sems: 1)
3	Cable cover R screw (M3 × 8, S tight cup: 2)

- 8. Remove the cable cover.

9. While rotating the damper fixing material, remove the eight ink tubes from the damper fixing material hook.

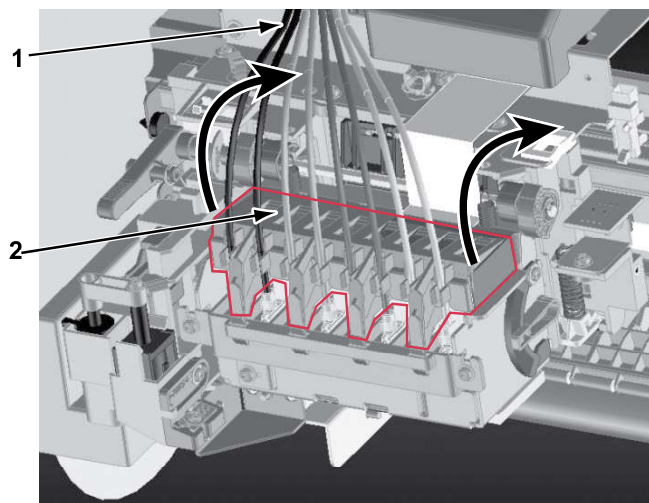

No.	Part name
1	Ink tube
2	Damper fixing material

10. Remove the damper fixing material.
11. Remove the eight damper assemblies connected to the print head that needs to be replaced, with a flat-head driver.

CAUTION

- Do not press the transparent film on the damper assembly with your hand. Doing so may discharge the ink filled inside the damper assembly.
- Be careful not to damage the transparent film on the damper assembly.

NOTE

When removing the damper assembly, note the following.

- To easily remove the damper assembly, insert a flat-head driver between the carriage and the damper assembly left protruding part, then pry out the damper assembly.
- To avoid residual ink leakage, place the removed damper on a rag.

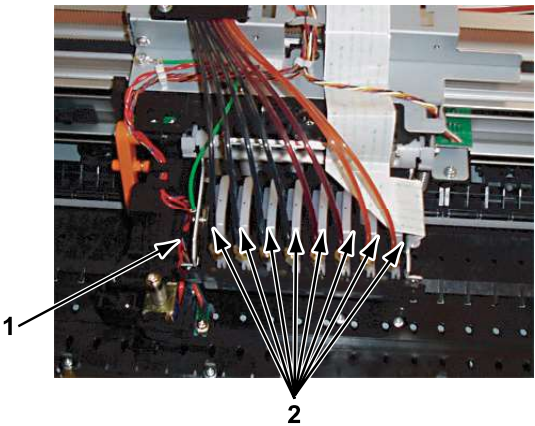

No.	Part name
1	Flat-head driver insertion point
2	Damper assembly

12. Remove the damper locating material-retaining screw (pan-head screw with spring washer and flat washer M3 × 6 W sems: 2).

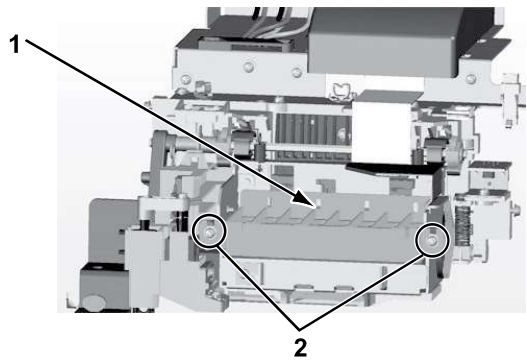

No.	Part name
1	Damper locating material
2	Damper locating material screw (pan-head screw with spring washer and flat washer M3 × 6 W sems)

13. Remove the damper locating material.
14. Remove the print head from the carriage.

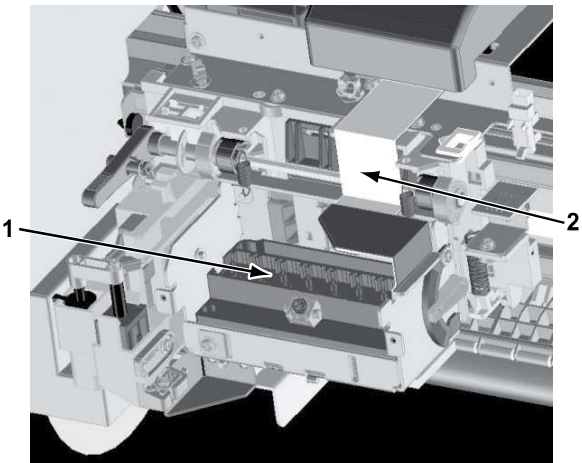

No.	Part name
1	Print head
2	Head tape wire

15. Remove the two head tape wire from the print head.

**CAUTION**

- The QR code label on the print head should be written down for later use or kept in a safe place.
 - Do not touch the nozzles of the print head. Make sure that the nozzles do not get any dust.
 - Before replacing board or connecting/removing tape wire (FFC), unplug the power cable and leave the printer for a while. Or board may be damaged by overcurrent.
 - When connecting or removing the tape wire (FFC), always pull or push the wire perpendicularly to the connector. Pulling or pushing the wire slantwise may damage/short/break the terminals in the connectors, resulting in a breakdown of the print head. You can connect/remove the tape wire up to five times.
 - The folding orientation of the FFC (tape wire) differs between head side and the CR board side. Make sure to attach the tape wire in the appropriate orientation.
-

16. Replace the print head.

17. To reassemble the unit, reverse the removal procedure.

18. Perform adjustments by following the instructions in ["7.2 Adjustment Item" p.7-3](#).