

■ Outline

Adjusts the location for capping and wiper. Adjusted value is saved in the system parameter.
Basically, it is not necessary to make adjustment even when cap (and the like) has been replaced.

■ Adjustment procedure

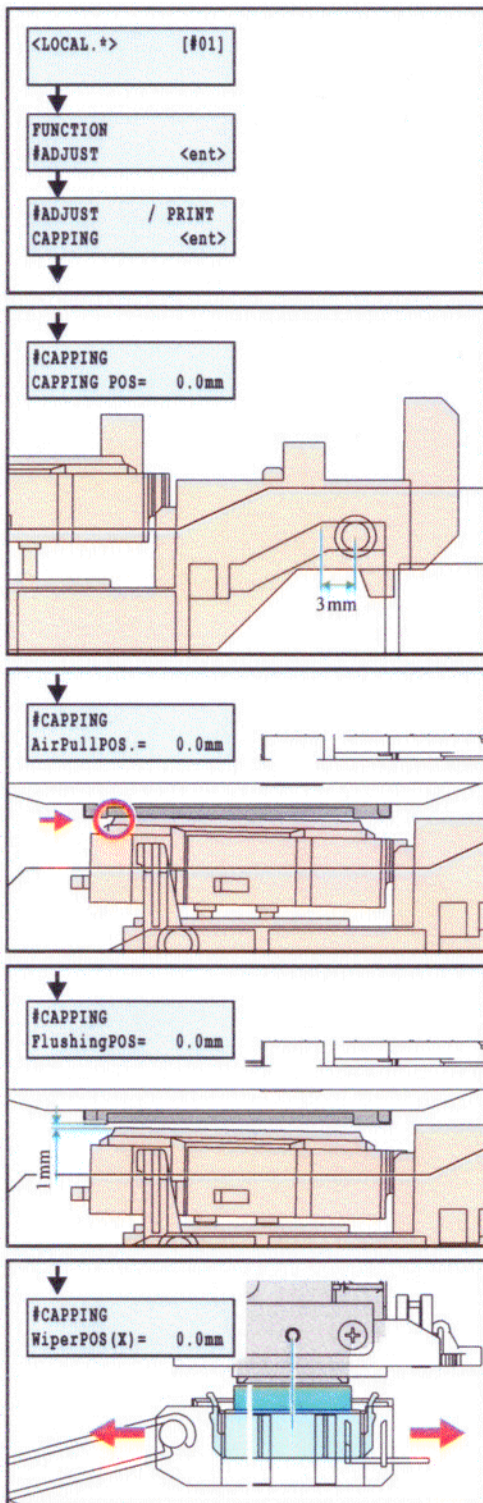

1. Select [CAPPING] from the operation menu.

2. Make adjustment so that the cap slider is located at 3 mm to the right from the uppermost point it has reached on the cap base.

[◀]/[▶]: Horizontally shifts the cap.
[ENTER]: Finalizes (To Next)

3. Make adjustment so that the head is located exactly at the point where the head is in contact with rubber portion (left end) of the cap head.

[▲]/[▼]: Shifts the cap.
[ENTER]: Finalizes (To Next)

4. Make adjustment so that the clearance between the head and left end of the cap is set at 1 mm.

[◀]/[▶]: Shifts the cap.
[ENTER]: Finalizes (To Next)

5. Make adjustment so that each center of the wiper and the head coincides.

[◀]/[▶]: Horizontally shifts the wiper.
[ENTER]: Finalizes
[END]: Completes

1

2

3

5

6

7

8