

Appendix C – Part Number Reference and Tool Tree

Use the GSP Part Number when ordering items. The Part ID Number may be noted on the item and is a helpful cross-reference when determining correct part numbers.

GSP Part Number	Part ID Number	Description
P81629A	301056-08	Reciprocating knife tool - 0.090 stroke / 7,000 rpm (standard)
P81630A	301056-09	Foam knife tool - 0.250 stroke / 1,750 rpm (option)
P81631A	320537-02	Drag knife tool - Foamcore (option)
P81632A	320143-01	Felt marker tool - holder assy (option)
P81633A	320537-00	Micrometer knife tool (option)
P81634A	320143-00	Pen tool - holder assy (option)
P81635A	320537-01	Precision knife tool (option)
P81855A	320401-00	Light Duty Router tool (standard)
P81857A	320140-04	Sword blade tool - holder assy (standard)
P81858A	320144-01	Creasing tool - wheel holder assy (standard)
P81859A	320541-00	Spring loaded knife assy (standard)
P81637A	320193-07A	Mat - 48" x 120" Poly Vacuum (M3000 / M1200)
P81638A	320216-03	Mat - 68" x 48" x 3/16" Thick felt (M1200)
P81639A	320216-00	Mat - 76" x 124" x 3/16" Thick felt (M3000)
P81837A	320186-02	Mat - Texon (M1200)
P81838A	320186-00	Mat - Texon (M3000)
P81640A	320542-01	Mat - Needled Polyester Green (M1200)
P81641A	320542-00	Mat - Needled Polyester Green (M3000)
P81642A	910246-16	Knife - #16 Hobby Blade
P81643A	914647	Screw - For collet #8-32 x 0.187 cup point - Bristol Head
P81839A	320556-00	Knife - 30 degree vinyl cutting blade

GERBER M Series Cutting System Flatbed Cutter - PART NUMBERS AND TOOL TREE

GSP Part Number	Part ID Number	Description
P81646A	910246	Knife - Blades #11 (box of 100)
P81647A	301439-01	Knife - 11066 (Matl = Micro grain Carbide)
P81648A	301439-02	Knife - (2.38 knife edge, Matl = Sub-Micron grade Carbide)
P81649A	301439-06	Knife - (2.88 knife edge, Matl = Sub-Micron grade Carbide)
P81650A	301439-07	Knife - (3.38 knife edge, Matl = Sub-Micron grade Carbide)
P81651A	301439-12	Knife - 2" High Density Foam Blade
P81652A	301439-05A	Knife - 2.38 knife edge, Carbide, Teflon coated
P81653A	301439-06A	Knife - 2.88 knife edge, Carbide, Teflon coated
P81654A	301439-08A	Knife - 3.38 knife edge, Carbide, Teflon coated
P81655A	301439-13	Knife - 3/8" Plastic Corrugated
P81659A	910246-03	Knife - Blade (30 deg) Carbon Std (0.026thk) #8-A
P81660A	910246-01	Knife - Blade (45 deg) Carbon Std (0.025thk) #8-B
P81661A	301439-04	Knife - 15mm Tri-wall
P81662A	300526-21	Knife- 30 deg edge - (Matl = HSS M2)
P81663A	300526-22	Knife - 45 deg double bevel edge - (Matl = HSS M2)
P81664A	300526-16	Knife - General purpose - (Matl = HSS M2)
P81665A	300526-29C	Knife - Point on centerline, 30 deg
P81666A	300526-24C	Knife - Point on centerline, 45 deg
P81667A	911972	Wrench - Spline Head, Size: .096, Short Arm, 6 Flute
P81668A	301439-14	Knife - Sword 60 Degree, Double edge, Double tip
P81670A	914967-00	Router Bit - .047 CED .18 CEL .125 Shank 1.5 OAL, 2 Flute
P81671A	914967-01	Router Bit - .062 CED .18 CEL .125 Shank 1.5 OAL, 2 Flute
P81672A	914967-02	Router Bit - .094 CED .18 CEL .125 Shank 1.5 OAL, 2 Flute
P81673A	914967-03	Router Bit - .125 CED 50 CEL .125 Shank 1.5 OGL - 2 Flute
P81674A	915239-03	Router Bit - 1/8 Shank (3317A)
P81675A	915239-05	Router Bit - 1/8 Shk 1/16 CED 3/16 EL
P81676A	915239-04	Router Bit - 1/8 Shk 1/16 CED 1/4 EL
P81677A	915239-06	Router Bit - 1/8 Shk 1/8 CED 1/2 EL
P81678A	915239-07	Router Bit - 1/8 Shk 1/8 CED 1/4 EL

GERBER M Series Cutting System Flatbed Cutter - PART NUMBERS AND TOOL TREE

GSP Part Number	Part ID Number	Description
P81679A	915239-02	Router Bit - 5mm Shank, 1.5" L
P81680A	915239-01	Router Bit - 5mm Shank - 70 mm L
P81681A	915239-00	Router Bit - 5mm Shank - 60 mm L
P81682A	910390-00	Pen - Refill Black
P81683A	910334-00	Pen - Refill Blue
P81684A	320170-07	Shoe - Router Chip Extraction Shoe Assembly
P81687A	303415-02	Collet - Carbide blade (0.25 x 0.062)
P81688A	303415-03	Collet - (.022) For #11 blade
P81691A	911686-00	Marker - Plastic felt tip cartridge (black)
P81692A	320152-07	Shoe - Small adjustable peelcoat and folding carton
P81693A	320152-04	Shoe - Small adjustable peelcoat and folding carton, nylatron
P81694A	320152-06	Shoe - Small (Tri-Wall, UHMW Poly.)
P81695A	320152-02	Shoe - Small (UHMW Polyethylene)

GERBER M Series Cutting System Flatbed Cutter - PART NUMBERS AND TOOL TREE

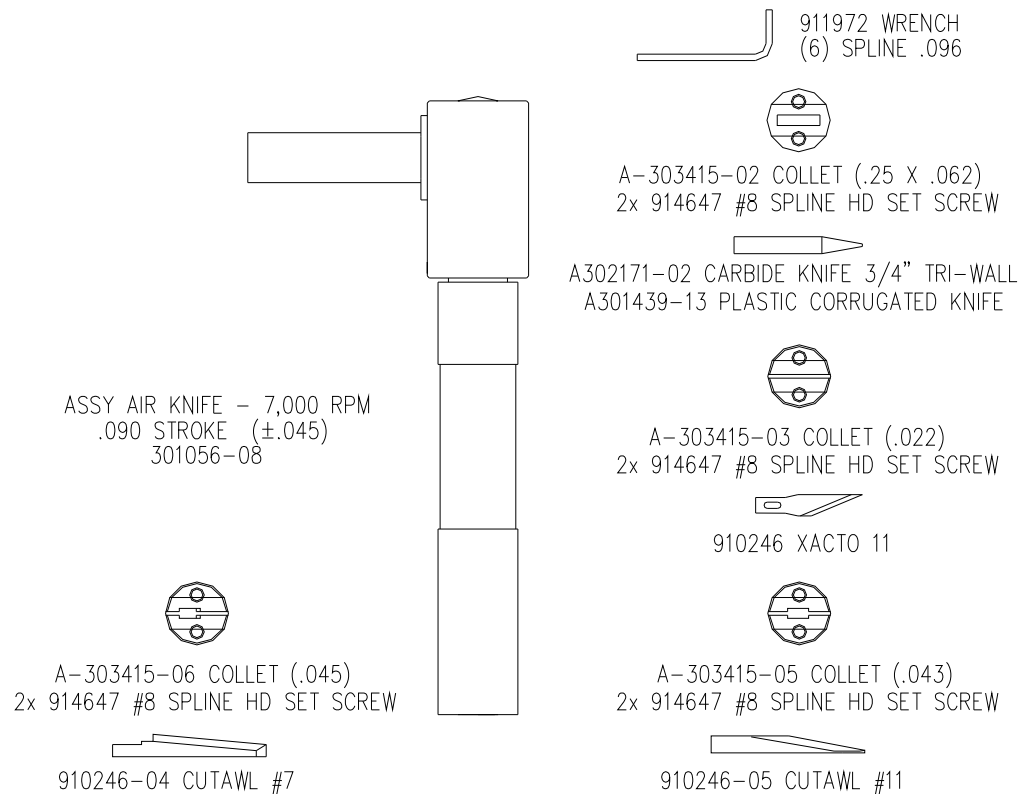
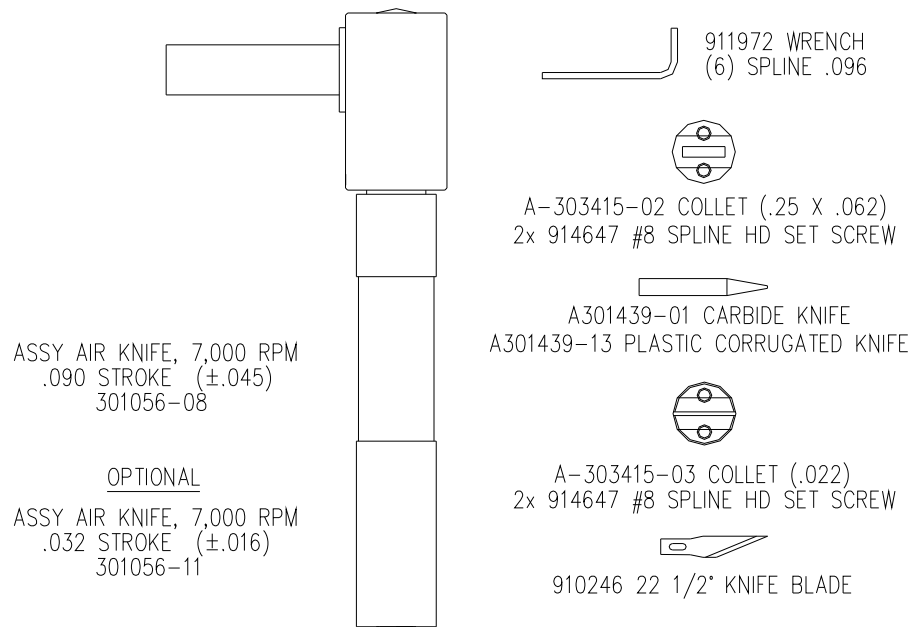

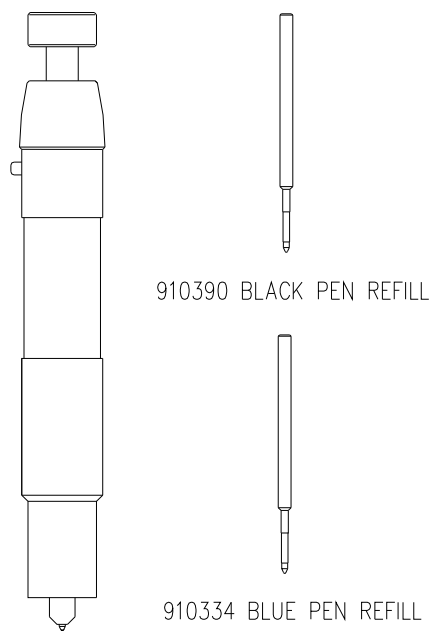

A320143-00 PEN HOLDER ASSY
(OPTIONAL A320143-02, -03)
(2nd & 3rd PEN HOLDER ASSY)

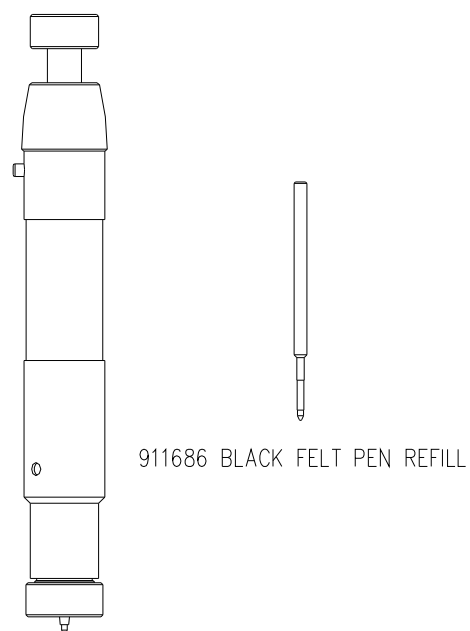

B320143-01 FELT PEN HOLDER ASSY

GERBER M Series Cutting System Flatbed Cutter - PART NUMBERS AND TOOL TREE

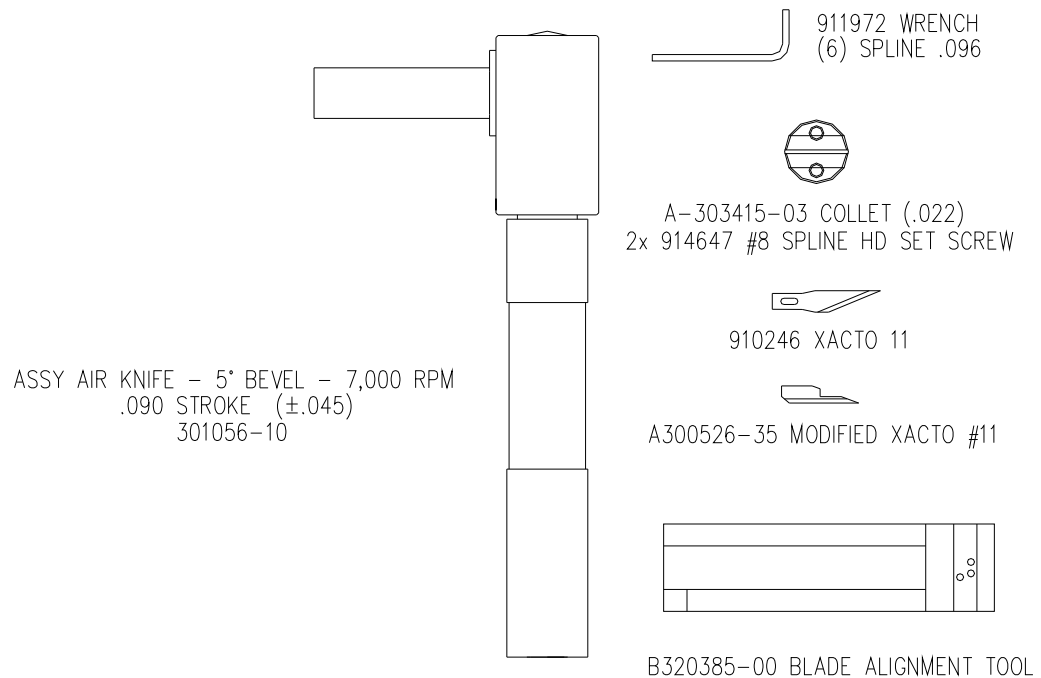
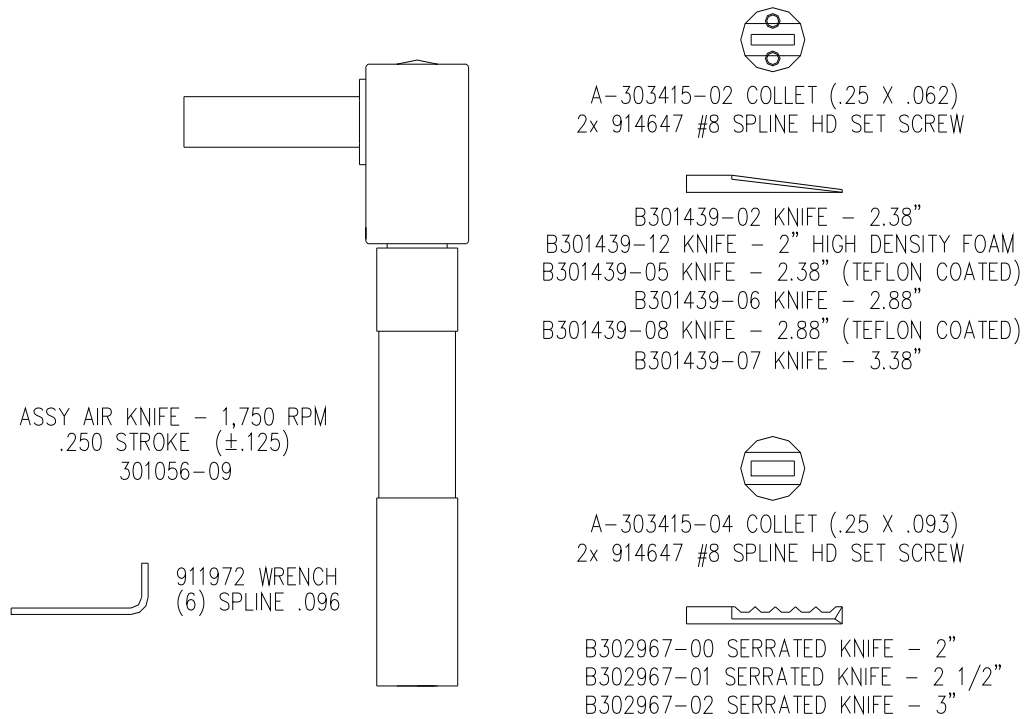

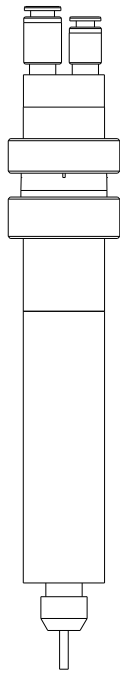

915036-00	$\frac{3}{32}$ " COLLET
915037-00	$\frac{1}{8}$ " COLLET
915035-00	3MM COLLET
915035-01	5MM COLLET
915035-02	6MM COLLET



915239-00	5MM, 16MM CEL 1 FLUTE 'O' GRIND
915239-01	5MM, 30MM CEL 1 FLUTE 'O' GRIND
915239-03	$\frac{1}{8}$, $\frac{5}{16}$ CEL 1 FLUTE 'O' GRIND
915239-04	$\frac{1}{8}$, $\frac{1}{16}$ CED, $\frac{1}{4}$ CEL 1 FLUTE
915239-05	$\frac{1}{8}$, $\frac{1}{16}$ CED, $\frac{3}{16}$ CEL 2 FLUTE SPIRAL
915239-06	$\frac{1}{8}$, $\frac{1}{2}$ CEL 2 FLUTE SPIRAL
915239-07	$\frac{1}{8}$, $\frac{1}{4}$ CEL 2 FLUTE SPIRAL

320405 LIGHT DUTY ROUTER OPTION
 (B320401 LIGHT DUTY ROUTER)
 (C320440 CHIP EXTRACTOR ASSY)

GERBER M Series Cutting System Flatbed Cutter - PART NUMBERS AND TOOL TREE

NOTE - USE WITH TOP WHEELS - B-301283-02,-03
NOTE - USE WITH BOTTOM WHEELS - B-301292-02,-03

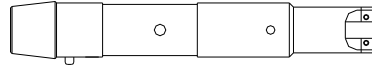

A320144-00 FOLDING WHEEL HOLDER



A320144-03 FOLDING WHEEL HOLDER
(1/2 DIA WHEEL ASSY)

NOTE - USE WITH WHEEL ASSYS - A-320315-00,-01



A-320141-00



A-320141-01

NOTE - USE WITH WHEELS



A-320141-04



A-320141-05

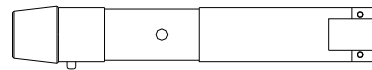

A320144-01 CORRUGATED WHEEL HOLDER

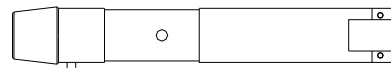

A320144-04 PLASTIC CORRUGATED WHEEL HOLDER
"HIGH FORCE USING Z-AXIS"



A-320141-02

NOTE - USE WITH WHEELS



A-320141-03

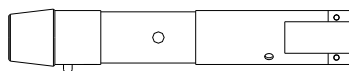

A320144-02 TRI-WALL WHEEL HOLDER

Shenzhen Oyea Machinery Co., Ltd.

GERBER M Series Cutting System Flatbed Cutter - PART NUMBERS AND TOOL TREE

STANDARD

NOTE - USE BLADE B300526-16 GENERAL PURPOSE (3/16" DIA)

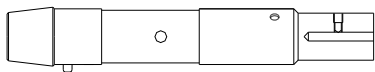

A320140-02 3/16 DIA BLADE HOLDER

OPTIONAL

OPTIONAL BLADES FOR STANDARD A320140-02 3/16" DIA HOLDER
B300526-17 THRU -32 AND -36 THRU -38

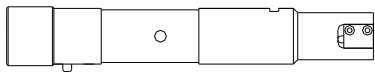

A320140-00 1/16 x 1/8 BLADE HOLDER

NOTE - USE BLADE A-300526-33

(2x 914639 SHCS #5-40 X 3/8)
(911642 T-HANDLE WRENCH #5)

OPTIONAL

NOTE - USE BLADES
(.025 X .320 MAX)

910246-03 (GRIFHOLD #8-A)

910246-01 (GRIFHOLD #8-B)

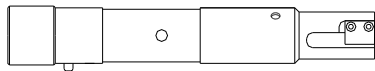

A320140-01 .025 x .320 BLADE HOLDER

(2x 914639 SHCS #5-40 X 3/8)
(911642 T-HANDLE WRENCH #5)

320538-00 BOX CUTTER KNIFE OPTION

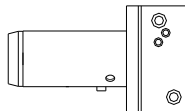

A320142-00 SLITTER BLADE HOLDER (TRI-WALL)

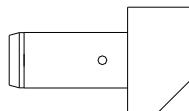

A320142-01 BEVEL BLADE HOLDER (TRI-WALL)

NOTE - BOTH USE WITH BLADE 910246-11

* NOTE - BOTH HOLDERS REQUIRE
A320145 DRAWBAR ASSY

GERBER M Series Cutting System Flatbed Cutter - PART NUMBERS AND TOOL TREE



B301439-14
60 DEGREE
SWORD BLADE

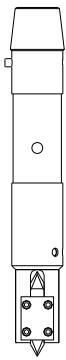

B320140-04 SWORD
DRAG KNIFE HOLDER
(THIN PHENOLIC)

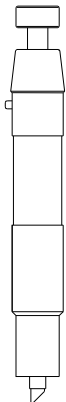

320556-00
30 DEGREE
BLADE

B320541-00 SPRING
LOADED VINYL KNIFE
(VINYL)



910246-16
#16 HOBBY BLADE

(4x 914639 SHCS #5-40 X 3/8)
(911642 T-HANDLE WRENCH #5)



320537 MICROMETER KNIFE OPTION
B320140-03 MICROMETER DRAG KNIFE