

The Slatz System offers both simplicity and sophistication in one dynamic sign system.

Each Slatz sign configuration is derived from one of two basic construction methods: single-panel or multi-panel.

Single-panel signs consist of a faceplate extrusion (Group I) and a corresponding end cap. The cap serves three purposes. It conceals cut ends, provides a mounting method, and gives intermediate support for long panels.

Multi-panel signs are created by combining faceplates, trimplates and sidetracks which house a series of precision-molded multiclips.

SINGLE-PANEL CONSTRUCTION

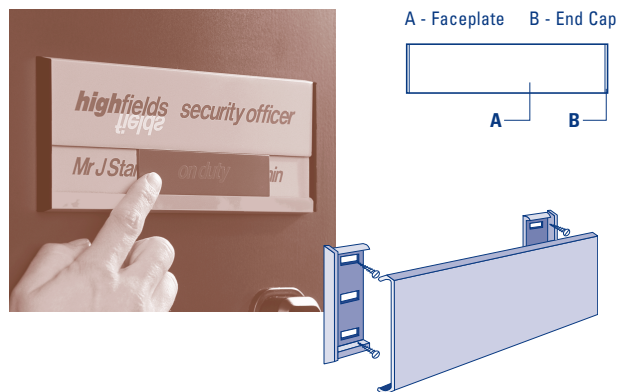

The Slatz end cap does dual duty as a mounting bracket and finishing feature. Available in sizes to fit each Slatz faceplate extrusion, the caps are used to mount single-panel signs. They are ideal for nameplates, desk signs, restrooms and single-message communication.

MULTI-PANEL CONSTRUCTION



At the heart of a multi-panel Slatz sign is the multiclip. Inserted into aluminum sidetracks, multiclips hold multiple faceplates in limitless combinations to form everything from basic wall directional signs to complex directories and displays.

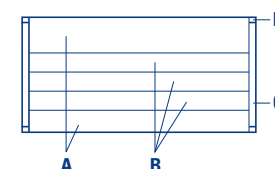

A - Trimplate
B - Faceplates
C - Sidetrack
D - Sidetrack Cap
E - Multiclip

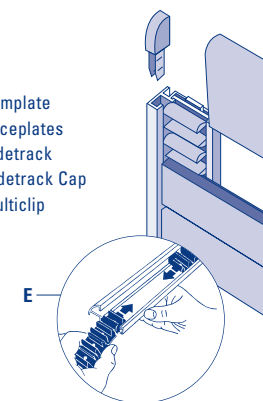

GROUP I

FACEPLATES

Faceplates are precision-engineered aluminum extrusions. Available in a silver satin finish or many shades from our exclusive Colorfix™ system.

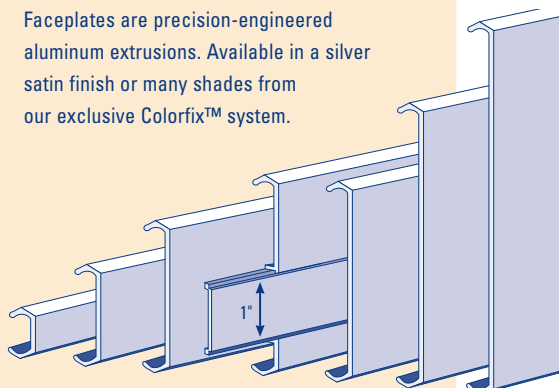

Mini	Little	Middle	Big Slider	Big	King	Super
5/8"	1-1/2"	2-1/4"	3-1/8"	3-1/8"	4-3/4"	6-5/16" face
13/16"	1-5/8"	2-3/8"	3-1/4"	3-1/4"	4-7/8"	6-7/16" overall

GROUP II

TRIMPLATES

Trimplates are similar in construction to faceplates except for a return on one edge. The return provides a flush wall mount and inhibits vandalism.

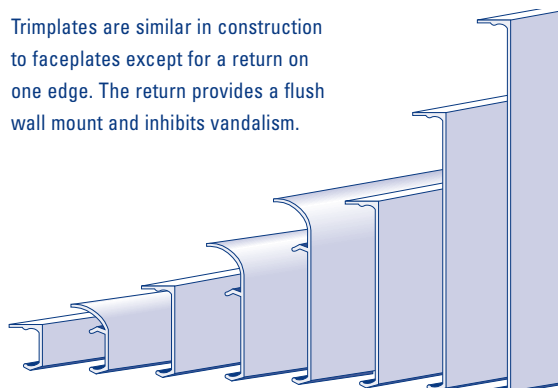

Square Mini	Curved Mini	Square Little	Curved Little	Curved Middle	Square Big	Square King	Square Super
13/16"	1-3/16"	1-9/16"	2-3/8"	3-3/16"	3-3/16"	4-7/8"	6-3/8"
overall height							

GROUP III

FRAMING OPTIONS

Framing options require two selections: trimplate and sidetrack.

1. Quad Track and Curved Trimplates
2. Square Track and Curved Trimplates
3. Angle Track and Square Trimplates
4. Quad Track and Square Trimplates
5. Square Track and Square Trimplates

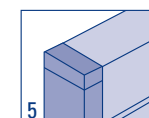
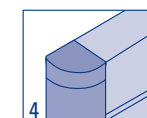
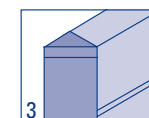
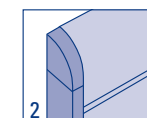
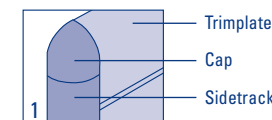

SIGN CONFIGURATIONS

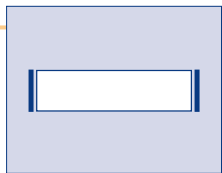

Wall Sign

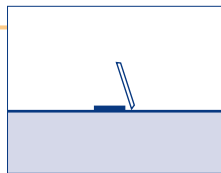

Desk Sign

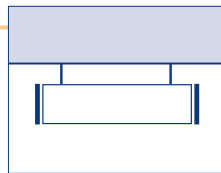

Suspended Sign

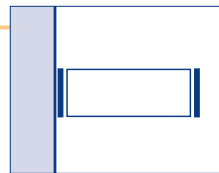

Projecting Sign



Single-column Directory

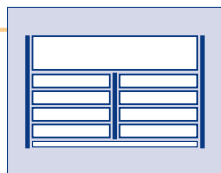

Multi-column Directory

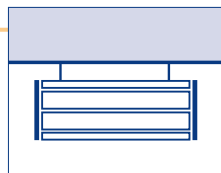

Suspended Directory

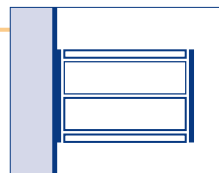

Projecting Directory

BASIC INSTALLATION INSTRUCTIONS:

Single-panel Slatz Signs

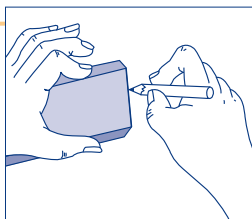

Hold plate on wall at desired location. Mark sides and corners.

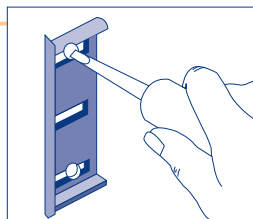

Remove end caps. Hold caps to corner markings and mark end cap mounting holes. Drill holes, insert anchors, and fasten caps to wall. Do not fasten tightly; allow for minor adjustment.

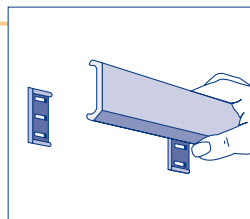

Snap faceplate into place.

Multi-panel Slatz Signs

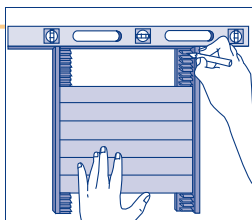

Remove plates, where shown, to expose mounting holes. Position on mounting surface, level, and mark holes.

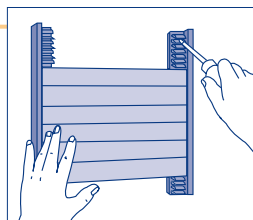

Drill holes and insert anchors. Line directory up to holes and fasten with screws.

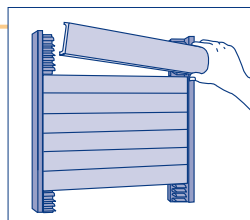

Replace plates.

FREQUENTLY ASKED QUESTIONS

Q : Is Slatz for interiors only, or can it be used outside?

A : Slatz has been used successfully in exterior sign programs around the world for years.

Q : Is the Slatz System compatible with ADA guidelines?

A : Yes. ADA-compatible signs may be achieved by applying ADA-approved materials to the faceplates.

Q : What are the options for ceiling installations?

A : Typical Slatz ceiling installations involve a ceiling clip that attaches to most common drop-ceiling channels. Additional methods are available. Please contact Clarke Systems Customer Service.

Q : Can Slatz Systems be framed?

A : Yes. Given the fact that the faceplates snap in from the front and can be removed from the front with a Slatz key, they can be framed and can be recessed in a structure.

Q : You have a variety of faceplates and trimplates. Are other sizes and shapes available?

A : Yes. Specialty extrusions, such as the Slatz Slider for "in-use/vacant" conference-room signage, custom-size panels, and extrusions that hold engraving stock, are available.

Q : How many colors are available?

A : The standard Slatz color is satin silver anodized. We also can provide Colorfix™ extrusions with a high-performance premium vinyl in a multitude of colors.